



# Anemostat®

AIR DISTRIBUTION

MODEL **SLUF8**

FEMA 361 STEEL LOUVER  
8" DEEP

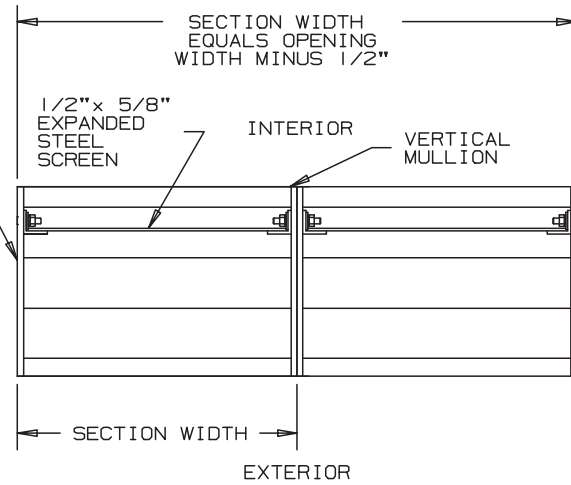
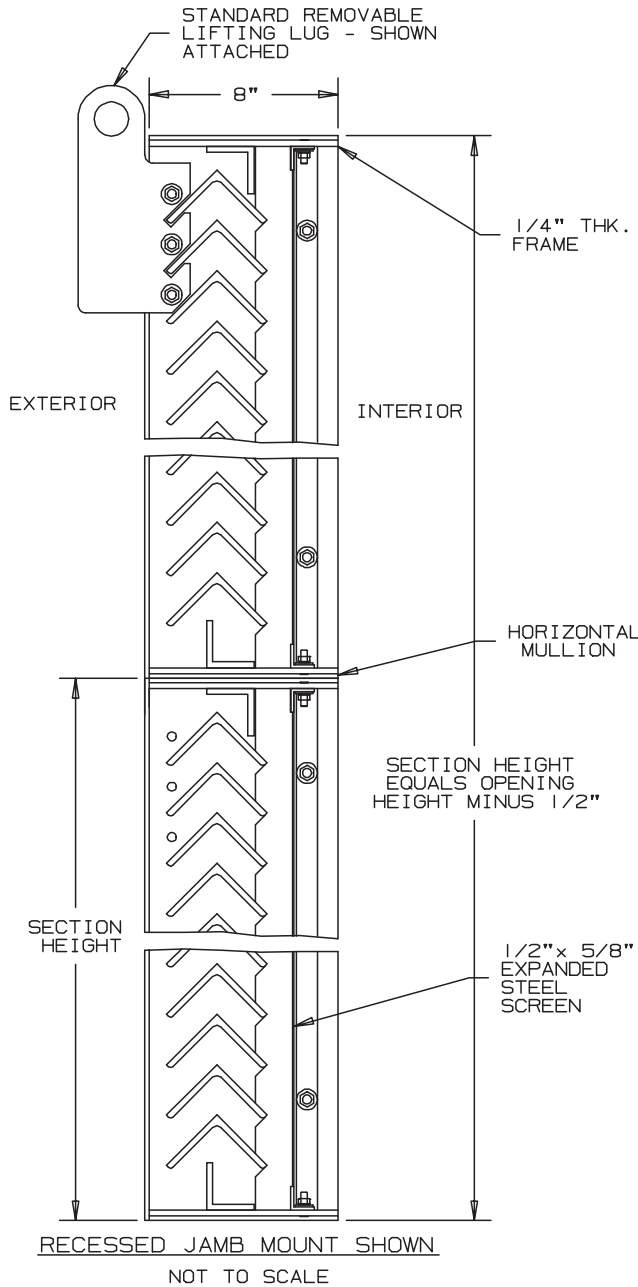

### SPECIFICATIONS

- FRAME: 1/4" HOT ROLLED STEEL
- BLADES: 3"x3"x 1/4" HOT ROLLED STRUCTURAL STEEL ANGLE
- SCREEN: 1/2"x18 GAUGE EXPANDED STEEL - LOCATED ON INTERIOR
- MAXIMUM PANEL SIZE: 96"x76" CONTINUOUS WIDE  
76"x120" CONTINUOUS HIGH
- MINIMUM PANEL SIZE: 12"x12"
- PSF RATING: 332.5 PSF DESIGN LOAD
- WEIGHT PER SQ. FT.: 40 POUNDS SQ/FT.
- TEST METHODS: ICC 500, FEMA 361, ASTM E330, ASTM 1886
- FREE AREA: 53% (8.47 SQ./FT.), FOR 48" x 48" SIZE.

TEST METHOD(S):  
 ICC 500-2008, STANDARD FOR THE DESIGN AND CONSTRUCTION OF STORM SHELTERS.  
 FEMA 361 2ND EDITION, SECTION 7 DEBRIS IMPACT PERFORMANCE CRITERIA FOR SAFE ROOMS.  
 ASTM E 330-02, TEST METHOD FOR STRUCTURAL PERFORMANCE OF WINDOWS, CURTAIN WALLS AND DOORS BY UNIFORM STATIC AIR PRESSURE DIFFERENCE.  
 ASTM E 1886-05, STANDARD TEST METHOD FOR PERFORMANCE OF EXTERIOR WINDOWS, CURTAIN WALLS, DOORS AND IMPACT PROTECTIVE SYSTEMS IMPACTED BY MISSILE(S) AND EXPOSED TO CYCLIC PRESSURE DIFFERENTIALS.

NOMINAL DEDUCTIONS WILL BE MADE TO THE OPENING SIZE GIVEN.

| ITEM | QTY. | OPENING SIZE |        | LOUVER SIZE |        | MULL | SCREENS |     | UNION MADE |
|------|------|--------------|--------|-------------|--------|------|---------|-----|------------|
|      |      | WIDTH        | HEIGHT | WIDTH       | HEIGHT |      | TYPE    | LOC |            |
|      |      |              |        |             |        |      |         |     |            |

**Anemostat Air Distribution**  
 1220 E. Watson Center Road  
 Carson, CA 90745  
 310-835-7500 • air@anemostat.com  
 www.anemostat-hvac.com

AGENT: \_\_\_\_\_

ARCH./ENG. : \_\_\_\_\_  
 CONTR. : \_\_\_\_\_  
 PROJECT : \_\_\_\_\_  
 EDR: \_\_\_\_\_ ECN: \_\_\_\_\_ JOB: \_\_\_\_\_  
 DATE: \_\_\_\_\_ DWN. : \_\_\_\_\_ DWG. : \_\_\_\_\_



# MODEL SLUF8

## 361 FEMA LOUVERS

### STEEL - STATIONARY

## PERFORMANCE DATA

### FREE AREA

|        |  | FREE AREA ( SQ. FT. ) |      |       |       |       |       |       |       |       |
|--------|--|-----------------------|------|-------|-------|-------|-------|-------|-------|-------|
|        |  | WIDTH                 |      |       |       |       |       |       |       |       |
| HEIGHT |  | 12"                   | 24"  | 36"   | 48"   | 60"   | 72"   | 76"   | 84"   | 96"   |
|        |  | 12"                   |      | .36   | .91   | 1.47  | 2.02  | 2.56  | 3.13  | 3.31  |
| 24"    |  | .75                   | 1.88 | 3.04  | 4.17  | 5.29  | 6.46  | 6.83  | 7.58  | 8.71  |
| 36"    |  | 1.14                  | 2.84 | 4.61  | 6.32  | 8.02  | 9.79  | 10.36 | 11.50 | 13.21 |
| 48"    |  | 1.53                  | 3.81 | 6.18  | 8.47  | 10.76 | 13.13 | 13.89 | 15.41 | 17.71 |
| 60"    |  | 1.91                  | 4.78 | 7.75  | 10.62 | 13.49 | 16.46 | 17.42 | 19.33 | 22.21 |
| 72"    |  | 2.30                  | 5.75 | 9.32  | 12.77 | 16.22 | 19.79 | 20.94 | 23.24 | 26.70 |
| 76"    |  | 2.43                  | 6.07 | 9.85  | 13.49 | 17.13 | 20.90 | 22.12 | 27.15 | 31.20 |
| 84"    |  | 2.69                  | 6.72 | 10.89 | 14.92 | 18.95 | 23.13 | 24.47 | 31.07 | 31.20 |
| 96"    |  | 3.08                  | 7.69 | 12.46 | 17.07 | 21.68 | 26.46 | 28.00 | 34.98 | 35.70 |
| 108"   |  | 3.46                  | 8.65 | 14.03 | 19.22 | 24.41 | 29.79 | 31.53 |       |       |
| 120"   |  | 3.85                  | 9.62 | 15.60 | 21.37 | 27.15 | 33.13 | 35.05 |       |       |

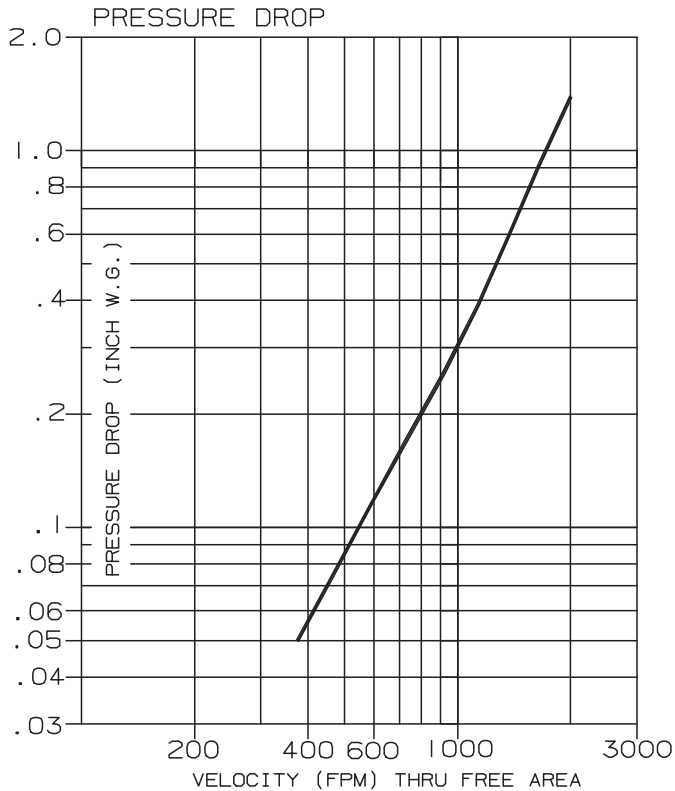

RATINGS DO NOT INCLUDE THE EFFECT OF A WIRE BIRD SCREEN  
TESTS BASED ON A 48"x48" TEST SIZE.

| FASTENER SCHEDULE   |           |                   |                    |
|---|-----------|-------------------|--------------------|
| ANCHOR TYPE   | SUBSTRATE | MINIMUM EMBEDMENT | MINIMUM EDGE DIST. |
| (1) 1/2"x3" RED HEAD LDT  | CMU       | 2 1/2"            | 3 1/4"             |
| (1) 1/2"x3" RED HEAD LDT  | CONCRETE  | 2 1/2"            | 3 1/4"             |
| (2) 2"x1/2" GRADE 5 BOLT  | STEEL     | FULL              | 3/4"               |
| (1) CONCRETE SCREWS SHALL BE RED HEAD LDT ZINC COATED CONCRETE SCREWS |           |                   |                    |
| (2) BOLTS SHALL BE A MINIMUM GRADE 5                                  |           |                   |                    |

# MODEL SLUF8 FEMA 361 LOUVER MOUNTING DETAILS

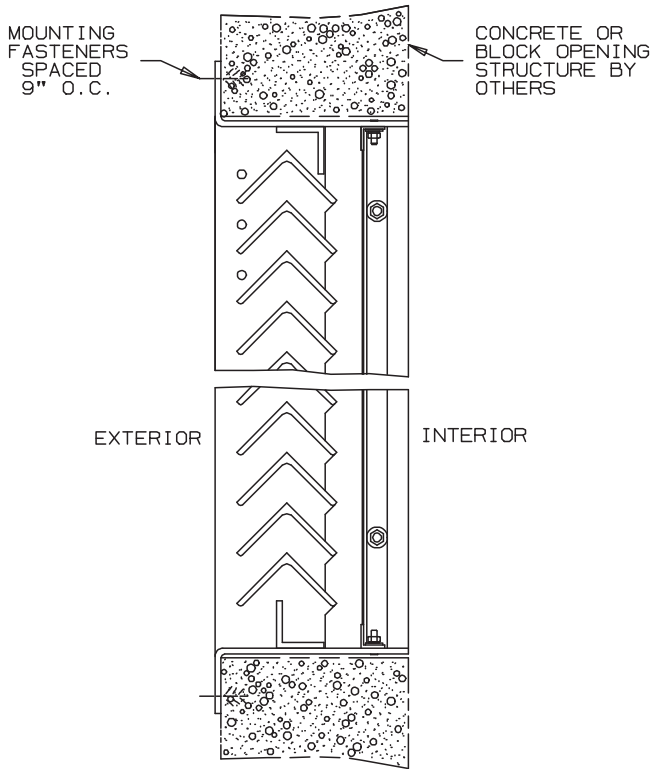

SLUF8 VERTICAL SECTION VIEW  
RECESSED MOUNT IN OPENING

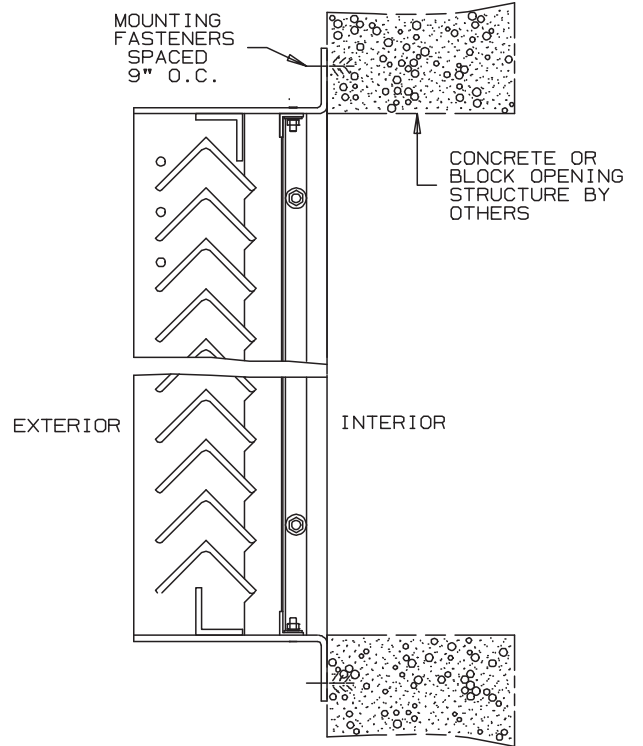

SLUF8 VERTICAL SECTION VIEW  
FLUSH MOUNT ON OPENING

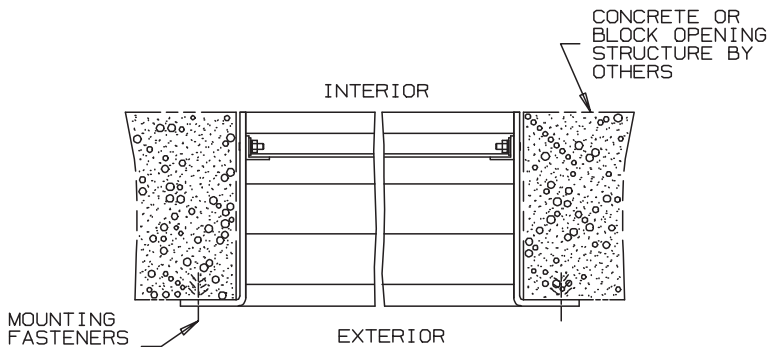

SLUF8 HORIZONTAL SECTION VIEW  
RECESSED MOUNT IN OPENING

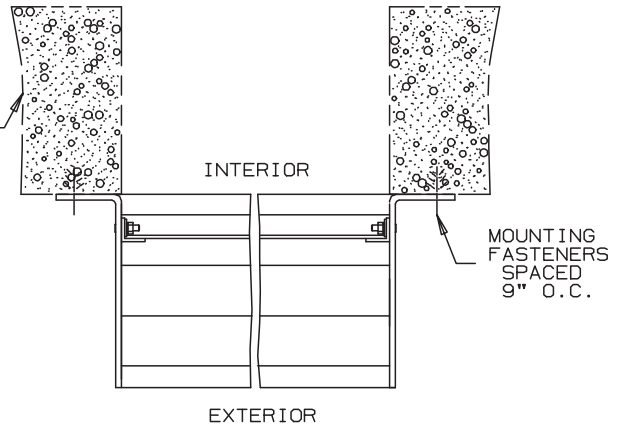

SLUF8 HORIZONTAL SECTION VIEW  
FLUSH MOUNT ON OPENING

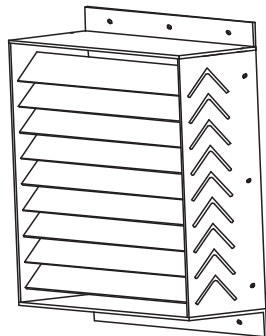

FLUSH MOUNT  
HEAD & SILL

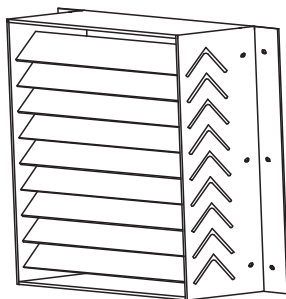

FLUSH MOUNT  
JAMBS

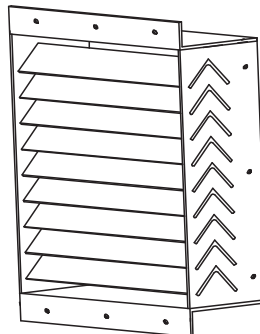

RECESSED MOUNT  
HEAD & SILL

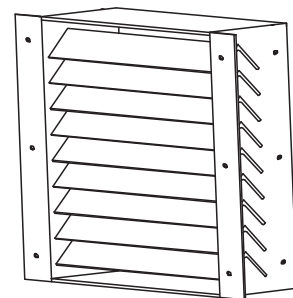

RECESSED MOUNT  
JAMBS

FLANGE MOUNTING OPTIONS