

SUBMITTAL SHEET

www.anemostat-hvac.com

1-1/2" SLOT WIDTH
FLUSH FRAME (W1)
PRODUCT FEATURES

- Adjustable volume and pattern controllers
- Flush mounting frame
- Hardware package includes duct mounting brackets & screws, and alignment strips (where applicable)
- Anemostat Model AD plenums are ordered and shipped separate from the diffusers
- Nominal Length is the order size
- Flush end caps are removable

CONSTRUCTION FEATURES
Material: Extruded Aluminum

Finish:

- ☐ Arctic White
(Black Pattern/Volume Controllers)
- ☐ Natural Anodize
(Black Pattern/Volume Controllers)
- ☐ Custom Color : _____

SUPPLY MODELS

- ☐ **FF-W1-150** 1-1/2" Slot Width (1-4 slots)

RETURN MODELS (No Internal Controllers)

- ☐ **FFR-W1-150** 1-1/2" Slot Width (1-4 slots)

OPTIONS

- ☐ **AD** Engineered Air Distribution Plenum
- ☐ **LEC** Linear Egg Crate
- ☐ **LED** Linear Equalizing Deflector

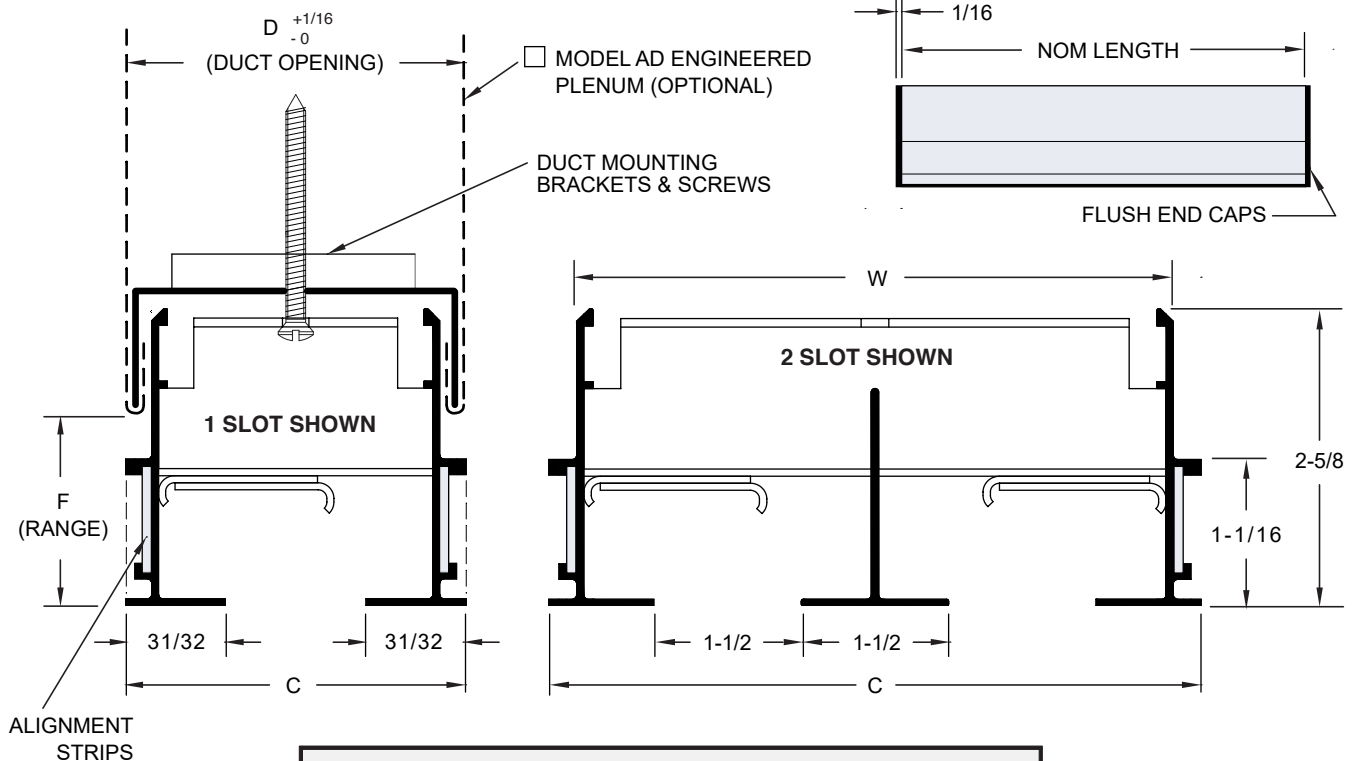

| FF-W1-150 • 1-1/2" SLOT WIDTH | | | | |
|-------------------------------|---------|---------|---------|-------------------------|
| # SLOTS | W | C | D | F |
| 1 | 3-1/16 | 3-7/16 | 3-5/16 | 1-25/32 to 2-5/32 |
| 2 | 6-1/16 | 6-7/16 | 6-5/16 | |
| 3 | 9-1/16 | 9-7/16 | 9-5/16 | |
| 4 | 12-1/16 | 12-7/16 | 12-5/16 | |

All dimensions are in inches.

JOB NAME:
SUBMITTED BY: